

# Straight Monorail

RAIL-ST- I.I



## GENERAL PRODUCT INFORMATION:



Standard Monorail bends horizontally to a radius as small as 6" and vertically to a radius as small as 24".



## Bending the Monorail

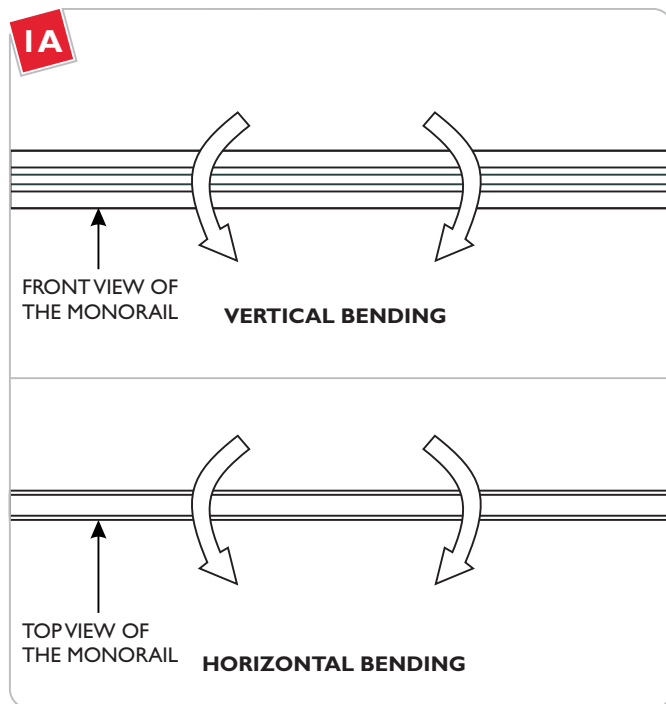

**NOTE:** There are three techniques for bending the Monorail horizontally, Plywood Template, Wiremold Pipe Bender, and Freestyle. When bending the Monorail vertically, only use the Wiremold Pipe Bender technique. Monorail bends horizontally easier than vertically. When bending the Monorail vertically, do small bends at a time and avoid bending the Monorail back which may cause the rails to separate from the insulator.

## Plywood Template to Form a Curve or Circle (Horizontal Bend Only)

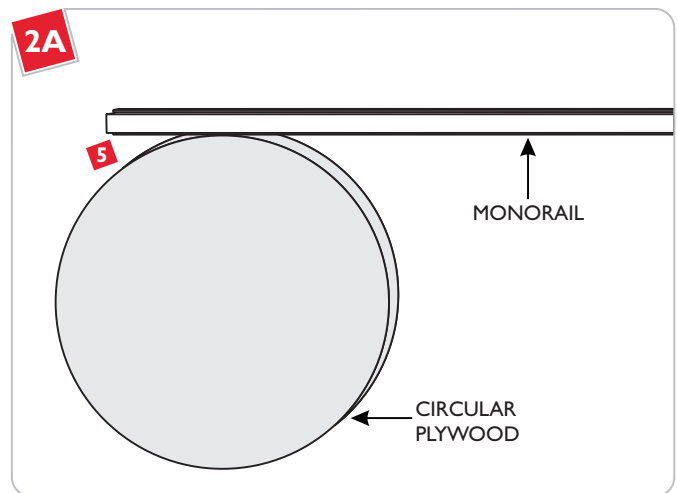

- 1 Determine the radius of the curve or circle.
- 2 On a piece of plywood draw the curved pattern.
- 3 Cut out the curved pattern from the plywood.
- 4 Make sure the cutout plywood is secured in place.
- 5 Hold one edge of the Monorail against the plywood.

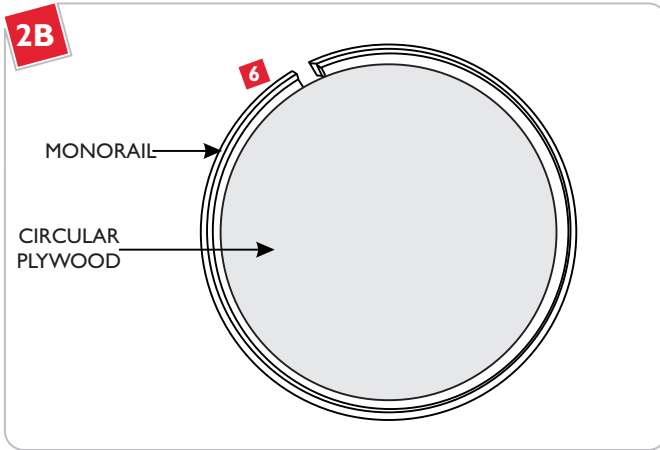

- 6 Start bending the rest of the Monorail against the circular plywood until the desired curve or circle is achieved.

## Wiremold Pipe Bender (Horizontal or Vertical Bend)

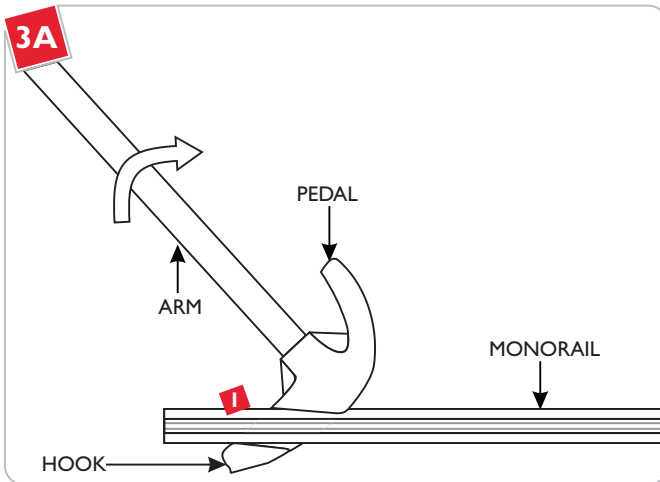

**NOTE:** The Wiremold Pipe Bender can be used to create smooth horizontal curve of 90° or less. Avoid stepping on the pedal of the Pipe Bender which will flatten and damage the Monorail.

- 1 Feed the Monorail through the Pipe Bender hook. Start bending the Monorail by gently pulling back on the arm of the Pipe Bender.
- 2 Start with small angle (MAX 10°) to avoid errors in shaping the Monorail. After each bend unhook and check the Monorail against the pattern.

**SAVE THESE INSTRUCTIONS!**

## Freestyle Bending (Horizontal Bend Only)

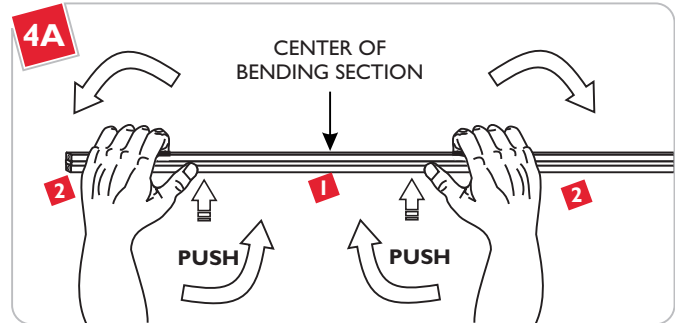

- 1 Choose the center of bending section on the Monorail. The bending point should be centered between the hands.
- 2 To ensure a smooth curve, begin with hands as far as apart as possible, moving the hands closer together as bending progresses. Bend the Monorail until the desired shape is achieved.

## Connecting the Monorail Sections

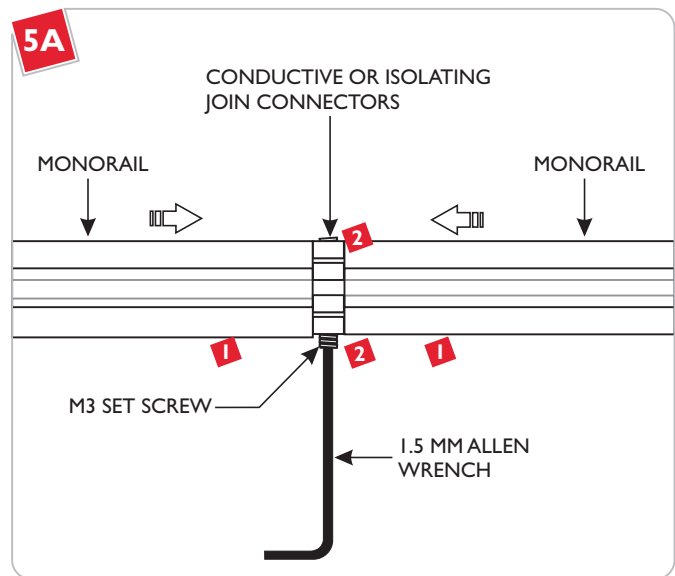

- 1 Push two Monorail sections completely onto the conductive or isolating joint connectors.
- 2 Tighten the M3 set screws with the 1.5 MM Allen wrench provided. Make sure that the set screw connection for conductive connector is tight to avoid heat build up and corrosion. For the isolating connector, tighten the #6-32 set screw firmly to avoid stripping the thread.

**LBL Lighting**

7400 Linder Ave, Skokie, IL 60077

800.323.3226 - 847.626.6300

[www.lblighting.com](http://www.lblighting.com)

© 2008 LBL Lighting. All rights reserved. The "LBL Lighting" graphic is a registered trademark of LBL Lighting. LBL Lighting reserves the right to change specifications for product improvements without notification.

A Generation Brands Company